

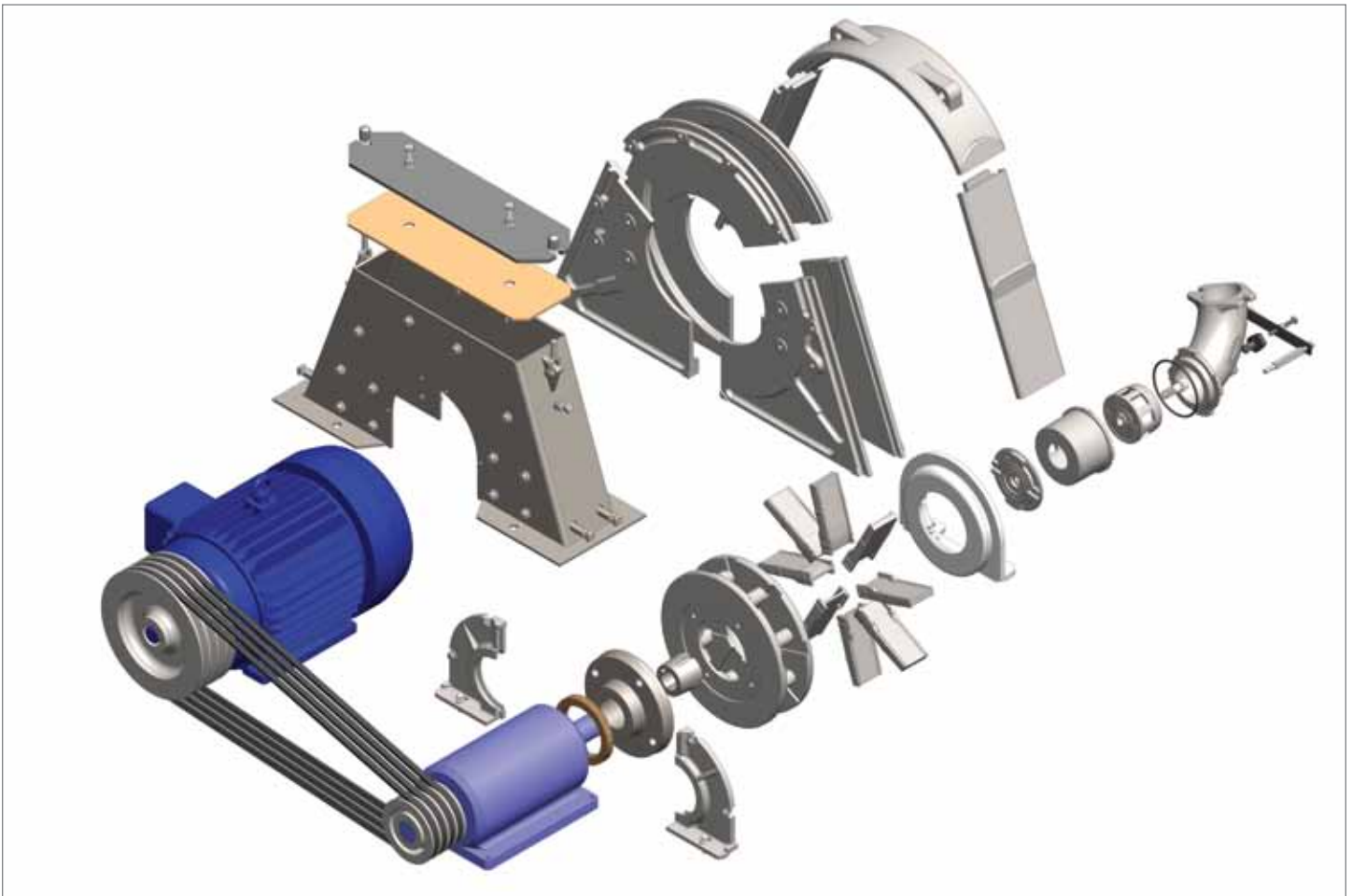

## **RLM BLAST WHEEL REPLACEMENT PARTS**

*Premium OEM Replacement Components for Wheelabrator® RLM™ Blast Wheels*



- 100% in-stock guaranteed
- Same day shipment available
- Premium cast chrome alloy, heat treated components
- Available products for 19.5" RLM wheels with 30, 49 and 70 degree control cages
- Multiple M-CAST upgrades available



M-CAST™ is a trademark of Metcast Service Tech Resources Inc.  
RLM™ is a trademark of Wheelabrator Technologies Inc.  
Wheelabrator® is a registered trademark of Wheelabrator Technologies Inc.

**TECHNOLOGY. SERVICE. SOLUTIONS.**

# RLM BLAST WHEEL REPLACEMENT PARTS

Premium OEM Replacement Components for Wheelabrator® RLM™ Blast Wheels

## TUNE UP KITS

Includes: Blade set, control cage, impeller, impeller bolt, lockwasher and spout seal

| KIT P/N  | WHEEL TYPE | BLADE    | CAGE DEGREE | CONTROL CAGE | IMPELLER | IMPELLER BOLT | LOCKWASHER | SPOUT SEAL |
|----------|------------|----------|-------------|--------------|----------|---------------|------------|------------|
|          | 25RLM195   | M-444903 | 30DEG       | M-3659       | M-414370 | M-158063      | M-165790   | M-448251   |
| M-449507 | 25RLM195   | M-444903 | 49DEG       | M-441985     | M-414370 | M-158063      | M-165790   | M-448251   |
| M-444082 | 25RLM195   | M-444903 | 70DEG       | M-414371     | M-414370 | M-158063      | M-165790   | M-448251   |

## GENERAL COMPONENTS

| ITEM | DESCRIPTION                   | PART NUMBER  |
|------|-------------------------------|--------------|
| 1    | MOTOR                         | SEE NOTE "A" |
| 2    | HOUSING                       | M-235911     |
| 3    | LID SEAL                      | M-158082     |
| 4    | LID                           | M-281842     |
| 5    | SIDE LINERS                   | SEE CHART    |
| 6    | WHEEL LINERS                  | SEE CHART    |
| 7    | FEED SPOUT, 90 DEG.           | M-414396     |
| 8    | FEED SPOUT, STRAIGHT          | M-423249     |
| 9    | SPOUT SEAL                    | SEE CHART    |
| 10   | LOCKWASHER                    | SEE CHART    |
| 11   | IMPELLER BOLT                 | SEE CHART    |
| 12   | IMPELLER                      | SEE CHART    |
| 13   | CONTROL CAGE                  | SEE CHART    |
| 14   | CENTER PLATE                  | M-410789     |
| 15   | CONTROL CAGE ADAPTER          | M-451579     |
| 16   | BLADES, SET OF 8              | SEE CHART    |
| 17   | BARE WHEEL, CLOCKWISE         | M-414667     |
| 18   | BARE WHEEL, COUNTER CLOCKWISE | M-414665     |
| 19   | HUB SEAL, LH                  | M-458620     |
| 20   | HUB SEAL, RH                  | M-458621     |
| 21   | HUB                           | SEE CHART    |
| 22   | REAR SEAL, FELT               | M-164774     |
| 23   | BEARING UNIT                  | SEE CHART    |
| 24   | SHEAVES                       | SEE CHART    |

## LINERS

| WHEEL TYPE | CURVED TOP | END LINER, 20.25in LONG |
|------------|------------|-------------------------|
| 25RLM195   | M-298688   | M-298689                |

## HUBS

| PART NUMBER | NOTES         |
|-------------|---------------|
| M-153946    | STANDARD      |
| M-164667    | LONG          |
| M-670119    | REVERSE TAPER |

## BEARING UNIT & COMPONENTS

| SHAFT LENGTH | PART NUMBER | SPACER STOP | MOTOR SHEAVE | BEARING SHEAVE |
|--------------|-------------|-------------|--------------|----------------|
| 28.5in       | M-153939    | M-94880     | M-237595     | M-98812        |
| 28.8in       | M-164881    | M-196154    | M-237595     | M-98812        |
| 18.9in       | M-208200    | M-211913    | M-237595     | M-98812        |

Call us for heavy duty motor replacements.



M-CAST™ is a trademark of Metcast Service Tech Resources Inc.  
RLM™ is a trademark of Wheelabrator Technologies Inc.  
Wheelabrator® is a registered trademark of Wheelabrator Technologies Inc.

TECHNOLOGY. SERVICE. SOLUTIONS.

Phone: 262.785.7577 • Fax: 262.785.1066 • 16211 West Lincoln Avenue • New Berlin, WI 53151 • bct-us.com