

JOB:
 ORDER REVISION:
 WIN:

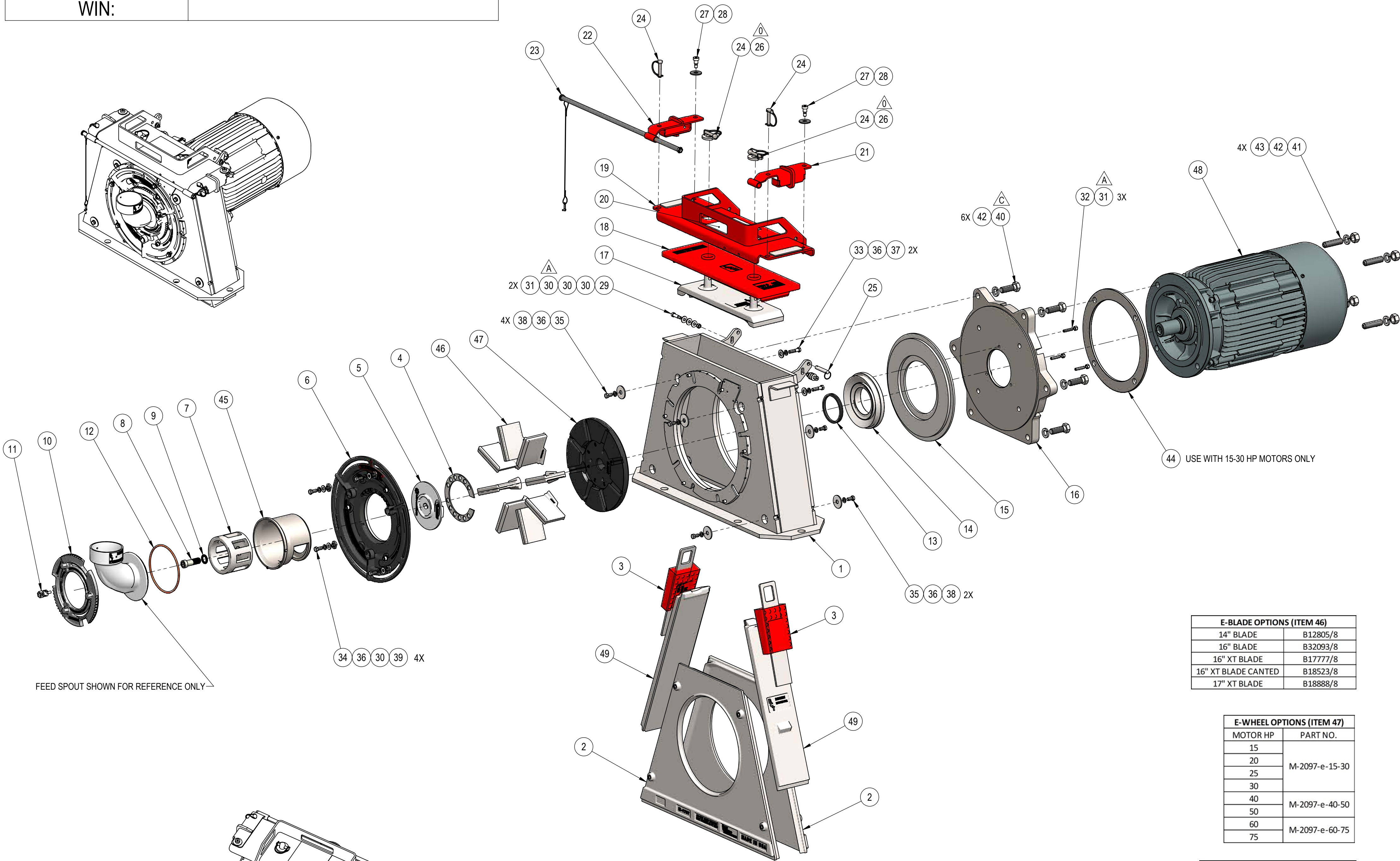

E-BLADE OPTIONS (ITEM 46)

14" BLADE	B12805/8
16" BLADE	B32093/8
16" XT BLADE	B17777/8
16" XT BLADE CANTED	B18523/8
17" XT BLADE	B18888/8

E-WHEEL OPTIONS (ITEM 47)

MOTOR HP	PART NO.
15	M-2097-e-15-30
20	
25	
30	
40	M-2097-e-40-50
50	
60	
75	M-2097-e-60-75

MOTOR SPACER RING OPTIONS (ITEM 44)

MOTOR HP	PART NO.
15-30 HP	M-2587 (DWG 11-1985-A)
40-75 HP	NO SPACER REQUIRED

CONTROL CAGE OPTIONS (ITEM 45)

SIZE	PART NO.
35°	B17861-35
50°	B17861-50
75°	B17861-75
95°	B17861-95

END LINER OPTIONS (ITEM 49)

OAL	PART NO.
23"	B1041631
26"	B1046426
29"	B1046429

FEED SPOUT OPTIONS (REF)

FEED SPOUT ANGLE	PART NO.
90°, 3.00" HOSE	B17886
90°, 3.50" HOSE	B22384
45°, 3.00" HOSE	B19184
45°, 3.50" HOSE	B19185
0°, 3.00" HOSE	B19186
0°, 3.50" HOSE	B19187

MOTOR OPTIONS (ITEM 48)

DESCRIPTION	PART NO.	WEIGHT
15 HP - 3600 RPM	M-3600-15-PE	280
	M-3600-15-XT	311
20 HP - 3600 RPM	M-3600-20-PE	295
	M-3600-20-XT	346
25 HP - 3600 RPM	M-3600-25-PE	415
	M-3600-25-XT	371
30 HP - 3600 RPM	M-3600-30-PE	450
	M-3600-30-XT	404
40 HP - 3600 RPM	M-3600-40-PE	486
	M-3600-40-XT	611
50 HP - 3600 RPM	M-3600-50-PE	753
	M-3600-50-XT	657
60 HP - 3600 RPM	M-3600-60-PE	1022
	M-3600-60-XT	858
75 HP - 3600 RPM	M-3600-75-PE	1045
	M-3600-75-XT	931

NOTE: SEE WIN #WHEEL ORDER FORM FOR ACTUAL OPTIONS SELECTED.

ITEM	WEIGHT	QTY.	DESCRIPTION	PART	DRAWING
1	227.24	1	TWISTLOK M3A HOUSING WELDMENT	B1044914	B1044914
2	44.25	2	FRONT SIDE LINER CAST	M-1707	12-4999-B
3	3.48	2	LINER WEDGE	M-6156	12-5252-B
4	0.39	1	INDEX RING, NUCKLESAVER	B17866	B17866
5	3.35	1	WEAR PLATE, NUCKLESAVER, TWISTLOK	B17873	B17873
6	35.82	1	CONTROL CAGE ADAPTER ASSY, TWISTLOK EXTREME DUTY	B26199	B26199
7	5.68	1	IMPELLER, TWISTLOK, 3.0 WIDE	B17860	B17860
8	0.33	1	IMPELLER BOLT	B12809	B12809
9	0.02	1	WASHER, WEDGE LOCK, .750, ZINC PLATED	MH-2373	-
10	4.94	1	TWISTLOK RING	B17863	B17863
11	0.11	1	M-LOK ASSY, .75 HEX, .8125 BODY	B22467	B22467
12	0.03	1	FEED SPOUT SEAL RING, TWISTLOK	B17918	B17918
13	13.82	1	V-RING SEAL	M-2938	-
14	8.75	1	MACHINED HUB SEAL	B12736	B12736
15	16.93	1	M3A REAR HUB LINER	B1044915	B1044915
16	56.24	1	CAST MOTOR MOUNT ONE SIDED DRAIN SLOTS	M-7475	13-6541-B
17	21.66	1	TOP LINER, M3 GEN 2	B1041630	B1041630
18	3.03	1	LID SEAL, M3 GEN2	B1041956	B1041956
19	22.35	1	LID WELDMENT, M3 GEN 2	B1042707	B1042707
20	0.27	1	E-WHEEL WARNING LABEL-LID LOCK	B14991	B14991
21	1.99	1	LID CLAMP, RH, 3.0 WHEEL	B14461	B14461
22	1.99	1	LID CLAMP, LH, 3.0 WHEEL	B14462	B14462
23	1.87	1	LID LOCK ASSY, 25.50 LG	B1041819	B1041819
24	0.11	4	PIN WITH RETAINER SNAP; 3/8 OD	M-3087	-
25	0.11	1	QUICK RELEASE PIN	MH-1511	-
26	0.16	2	WASHER, FABRICATED, 1.00 ID X 2.00 OD, .25 THK, STAINLESS	B1045760	B1045760
27	0.080	2	SCREW, SHC, SHOULDER, .50 DIA. X .50 LG, .375-16UNC X .625 LG, ASTM A574	MH-2351	-
28	0.025	2	WASHER, BELLEVILLE, .500 X 1.500 X .112 THK, STEEL	M-180771	-
29	0.056	2	SCREW, SHC, SHOULDER, .375 DIA. X 1.00 LG, .313-18UNC X .50 LG, ASTM A574	MH-2356	-
30	0.011	10	WASHER, FLAT, .312 TYPE A, WIDE (USS) STEEL	MH-1001	-
31	0.013	5	NUT, HEX, NYLON LOCK, .312-18UNC, STEEL, GR.8	MH-1560	-
32	0.031	3	SCR, SET, CUP POINT, .313-18UNC X 1.50 LG, STEEL, BLACK OXIDE	MH-2144	-
33	.064	2	SCR, HHC, .375-16UNC X 1.50 LG, GR.5	MH-1241	-
34	.038	4	SCR, HHC, .375-16UNC X .875 LG, GR.5	MH-1238	-
35	.041	6	SCR, HHC, .375-16UNC X .750 LG, GR.5	MH-1237	-
36	0.006	12	WASHER, LOCK, SPLIT, MEDIUM, .375, STEEL	MH-1011	-
37	0.018	2	WASHER, FLAT, .500 TYPE A, STANDARD (SAE) STEEL	MH-1388	-
38	.096	6	WASHER, FENDER, .500 X 1.75 OD, .125 THICK, STEEL, ZINC	MH-2436	-
39	0.04	4	T-NUT, .38-16NC THREAD	B17877	B17877
40	0.418	6	SCR, HHC, .750-10UNC X 2.25 LG, GR.5	MH-1330	-
41	0.353	4	SCR, SET, CUP POINT, .750-10UNC X 3.00 LG, STEEL ASME B18.3, ASTM F912, BLACK OXIDE	MH-2732	-
42	0.041	10	WASHER, LOCK, SPLIT, MEDIUM, .750, STEEL	MH-1015	-
43	0.117	4	NUT, HEX, FINISHED, .750-10UNC, STEEL GR.5	MH-1033	-
44	4.89	1	15-30 HP MOTOR SPACER RING	SEE TABLE	-
45	-	1	CONTROL CAGE	SEE TABLE	-
46	-	1	E BLADE, SET OF 8	SEE TABLE	-
47	-	1	E-WHEEL	SEE TABLE	-
48	-	1	MOTOR	SEE TABLE	-
49	-	2	M3 END LINER, GEN 2	SEE TABLE	-
653			APPROX TOTAL WEIGHT NOT INCLUDING MOTOR		

REVISIONS

REV.	ECN NO.	DESCRIPTION	DATE	BY
0	4799-1	RELEASED FOR PRODUCTION; REPLACED MH-2631 W/ B1045760	09/03/2021	KH
A	4861-2	REMOVED MH-1010 & MH-1028; ADDED QTY (2) MH-1001 & QTY (3) MH-1560	10/05/2021	KH
B	5183-10	ADDED END LINER OPTIONS TABLE	03/11/2022	KH
C	5545-18	REPLACED MH-1334 W/ MH-1330; REMOVED QTY (6) MH-1033	07/29/2022	KH

UNLESS OTHERWISE NOTED DIMENSIONS ARE IN INCHES TOLERANCES: ANGULAR: ±1° TWO PLACE DECIMAL ±0.007 THREE PLACE DECIMAL ±0.030"

MODELED BY: KH DATE: 07/09/2021
 DRAWN BY: KH DATE: 07/12/2021
 SIMILAR TO: [Symbol]

DESCRIPTION: TWISTLOK M3A ASSY

SIZE: D DWG NO: B1045003 REV: C

DO NOT SCALE DRAWING SCALE: 1:8 EST WT: 1048.98# SHEET 1 OF 1

SEE WHEEL ORDER FORM FOR CONDUIT BOX ORIENTATION