

JOB:  
ORDER REVISION:  
WIN:

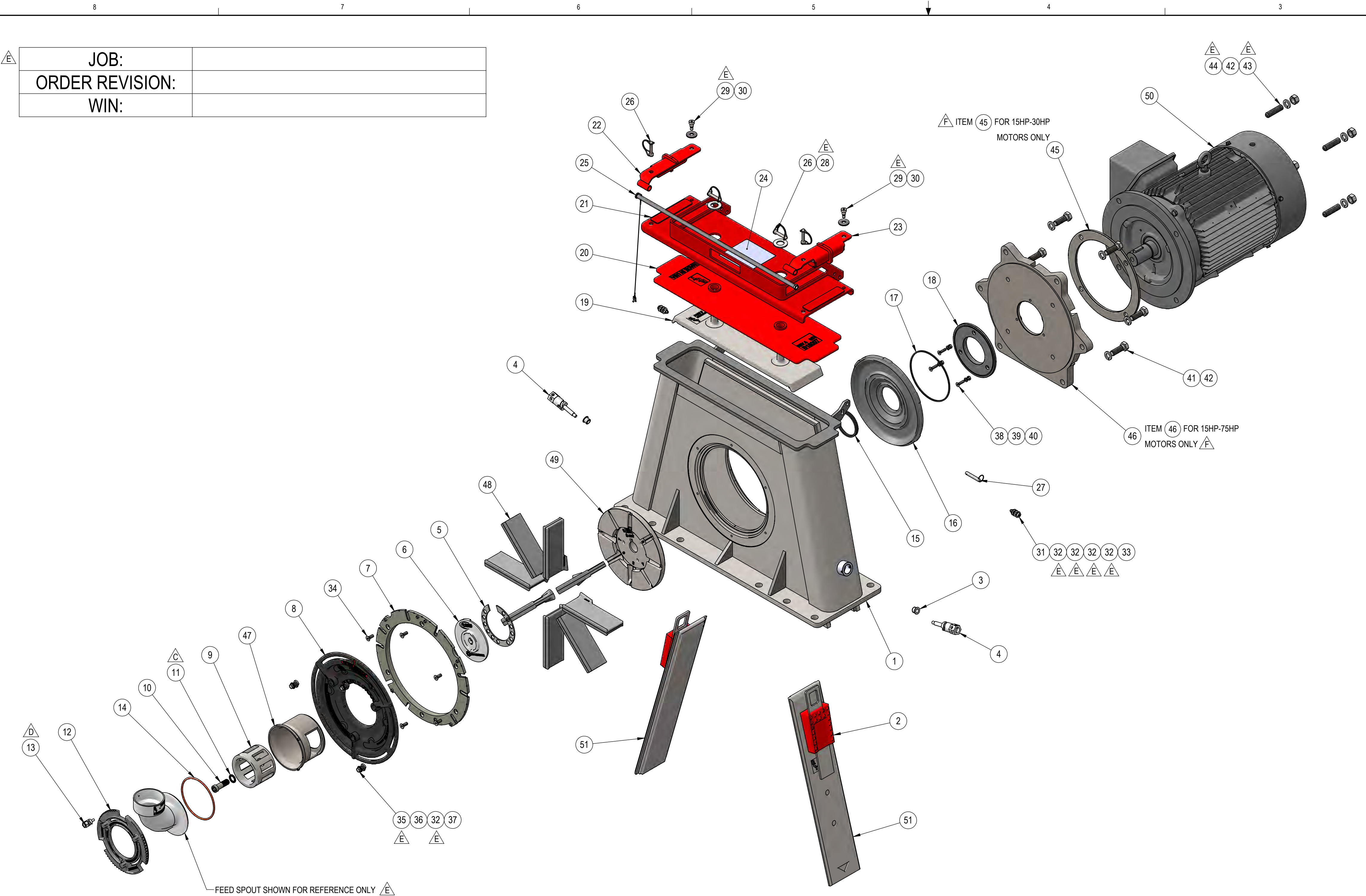

ITEM	WEIGHT	QTY	DESCRIPTION	PART	DRAWING
1	586.091	1	HOUSING WELDMENT, M5, EXTREME DUTY	B19601	B19601
2	3.48	2	LINER WEDGE	M-6156	12-5252-B
3	0.01	2	SEAL BUSHING, M-LOK PIN	B19029	B19029
4	0.72	2	M-LOK ASSY, 1.25 HEX, M5	B18015	B18015
5	0.39	1	INDEX RING, NUCKLESAVER	B17866	B17866
6	3.35	1	WEAR PLATE, NUCKLESAVER, TWISTLOK	B17873	B17873
7	11.35	1	T-NUT RING, TWISTLOK	B17875-N	B17875
8	22.76	1	CONTROL CAGE ADAPTER, TWISTLOK	B17862	B17862
9	5.68	1	IMPELLER, TWISTLOK, 3.0 WIDE	B17860	B17860
10	0.33	1	IMPELLER BOLT	B12809	B12809
11	0.02	1	WASHER, WEDGE LOCK, .750, ZINC PLATED	MH-2373	-
12	4.94	1	TWISTLOK RING	B17863	B17863
13	0.11	1	M-LOK ASSY, .75 HEX, .8125 BODY	B22467	B22467
14	0.03	1	FEED SPOUT SEAL RING, TWISTLOK	B17918	B17918
15	13.82	1	V-RING SEAL	M-2938	-
16	19.45	1	Cast Hubseal Liner M Series	M-5893	12-5001-B
17	0.02	1	O-RING, SQUARE PROFILE, 7.75 OD X 7.50 ID, BUNA-N 70 DURO, -.264	MH-2352	-
18	4.04	1	CAST HUB SEAL SPACER	B18011	B18011
19	35.61	1	TOP LINER, M5	B18008	B18008
20	4.38	1	LID SEAL, M5	B18007	B18007
21	32.23	1	LID WELDMENT, M5	B18014	B18014
22	2.39	1	LID CLAMP, LH, M5	B18013	B18013
23	2.39	1	LID CLAMP, RH, M5	B18012	B18012
24	0.27	1	E-WHEEL WARNING LABEL-LID LOCK	B14991	B14991
25	2.25	1	LID LOCK ASSY, 31.00 LG	B18019	B18019
26	0.11	4	PIN WITH RETAINER SNAP; 3/8 OD	M-3087	-
27	0.11	1	QUICK RELEASE PIN	MH-1511	-
28	0.089	2	WASHER, FLAT, 1.000 TYPE A, (SAE) HARDENED STEEL, YELLOW ZINC	MH-2631	-
29	0.080	2	SCREW, SHC, SHOULDER, .50 DIA. X .50 LG, .375-16UNC X .625 LG, ASTM A574	MH-2351	-
30	0.025	2	WASHER, BELLEVILLE, .500 X 1.500 X .112 THK, STEEL	M-180771	-
31	0.056	2	SCREW, SHC, SHOULDER, .375 DIA. X 1.00 LG, .313-18UNC X .50 LG, ASTM A574	MH-2356	-
32	0.011	12	WASHER, FLAT, .312 TYPE A, WIDE (USS) STEEL	MH-1001	-
33	0.013	2	NUT, HEX, NYLON LOCK, .312-18UNC, STEEL, GR.8	MH-1560	-
34	0.039	6	SCR, FHC, .375-16UNC X 1.00 LG, STEEL	MH-1645	-
35	.038	4	SCR, HHC, .375-16UNC X .875 LG, GR.5	MH-1238	-
36	0.006	4	WASHER, LOCK, SPLIT, MEDIUM, .375, STEEL	MH-1011	-
37	0.04	4	T-NUT, .38-16NC THREAD	B17877	B17877
38	0.031	3	SCR, FHC, .312-18UNC X 1.25 LG, STEEL	MH-2145	-
39	0.004	3	WASHER, LOCK, SPLIT, MEDIUM, .312, STEEL	MH-1010	-
40	0.01	3	NUT, HEX, FINISHED, .312-18UNC, STEEL GR.5	MH-1028	-
41	0.418	SEE TABLE	SCREW- SEE TABLE	SEE TABLE	-
42	0.041	SEE TABLE	WASHER, LOCK, SPLIT, MEDIUM, .750, STEEL	MH-1015	-
43	0.353	SEE TABLE	SCR, SET, CUP POINT, .750-10UNC X 3.00 LG, STEEL ASME B18.3, ASTM F912, BLACK OXIDE	MH-2732	-
44	0.117	SEE TABLE	NUT, HEX, FINISHED, .750-10UNC, STEEL GR.5	MH-1033	-
45	4.89	1	15-30 HP MOTOR SPACER RING	SEE TABLE	-
46	-	1	MOTOR MOUNT	SEE TABLE	-
47	-	1	CONTROL CAGE	SEE TABLE	-
48	-	1	E BLADE, SET OF 8	SEE TABLE	-
49	-	1	E-WHEEL	SEE TABLE	-
50	-	1	MOTOR	SEE TABLE	-
51	-	2	END LINER, M5	SEE TABLE	-
985			TOTAL WEIGHT NOT INCLUDING MOTOR		

**MOTOR OPTIONS (ITEM 50)**

DESCRIPTION	PART NO.	WEIGHT
15 HP - 1800 RPM	M-1800-15-PE	280
	M-1800-15-XT	353
20 HP - 1800 RPM	M-1800-20-PE	295
	M-1800-20-XT	353
25HP - 1800 RPM	M-1800-25-PE	415
	M-1800-25-XT	399
30 HP - 1800 RPM	M-1800-30-PE	450
	M-1800-30-XT	399
40 HP - 1800 RPM	M-1800-40-PE	486
	M-1800-40-XT	772
50 HP - 1800 RPM	M-1800-50-PE	753
	M-1800-50-XT	772
60 HP - 1800 RPM	M-1800-60-PE	1022
	M-1800-60-XT	1094
75 HP - 1800 RPM	M-1800-75-PE	1045
	M-1800-75-XT	1094
100 HP - 1800 RPM	M-1800-100-PE	1330
	M-1800-100-XT	1248
125 HP - 1800 RPM	M-1800-125-PE	1572

**E-WHEEL OPTIONS (ITEM 49)**

MOTOR HP	PART NO.
15	M-2097-e-15-30
20	
25	
30	
40	M-2097-e-40-50
50	
60	M-2097-e-60-75
75	
100	M-2097-e-60-75
125	

**BLADE OPTIONS (ITEM 48)**

DESCRIPTION	PART NO.
24" XT BLADE	B19777/8
25.5" XT BLADE	B19888/8
27" XT BLADE	B19999/8

**CONTROL CAGE OPTIONS (ITEM 47)**

SIZE	PART NO.
35"	B17861-35
50"	B17861-50
75"	B17861-75
95"	B17861-95

**END LINER OPTIONS (ITEM 51)**

OAL	PN COMBINATION
29"	B33529 (1)
	B12815 (1) & B12740 (1)
34"	B33534 (1)

**MOTOR SPACER RING OPTIONS (ITEM 45)**

MOTOR HP	PART NO.
15-30 HP	M-2587 (DWG 11-1985-A)
40-125 HP	NO SPACER REQUIRED

**FEED SPOUT OPTIONS (REF)**

FEED SPOUT ANGLE	PART NO.
90°, 3.00" HOSE	B17886
90°, 3.50" HOSE	B22384
45°, 3.00" HOSE	B19184
45°, 3.50" HOSE	B19185
0°, 3.00" HOSE	B19186
0°, 3.50" HOSE	B19187

**MOTOR MOUNT & HARDWARE (ITEMS 41,42,43,44, & 46)**

MOTOR HP	15-75HP	100-125 HP		
DESCRIPTION (ITEM #)	QTY	PART NO.	QTY	PART NO.
MOTOR MOUNT (ITEM 46)	1	M-7475 (DWG 13-6541-B)	1	B18010
SCREW (ITEM 41)	6	MH-1330	8	MH-2429
WASHER (ITEM 42)	4	MH-1015	8	MH-1015
SET SCREW (ITEM 43)	4	MH-2732	8	MH-2732
HEX NUT (ITEM 44)	4	MH-1033	8	MH-1033

NOTE: SEE SALES ORDER FOR SPECIFIC MOTOR CONFIGURATION.

UNLESS OTHERWISE NOTED DIMENSIONS ARE IN INCHES TOLERANCES: ANGULAR: ±1° TWO PLACE DECIMAL ±0.000° THREE PLACE DECIMAL ±0.000° FINISH: ✓ UNLESS OTHERWISE NOTED

MODELED BY: CB DATE: 06/06/2016  
DRAWN BY: CB DATE: 06/06/2016  
SIMILAR TO: [Symbol]

DESCRIPTION: M5 ASSY, TWISTLOK, EXTREME DUTY

SIZE: D DWG NO: B18105 REV: F

DO NOT SCALE DRAWING SCALE: 1:8 EST WT: 1630.05# SHEET 1 OF 2