

**NOTE:
ASSEMBLY DRAWING FOR REFERENCE,
VERIFY PART NUMBERS WITH FACTORY
PRIOR TO ORDERING**

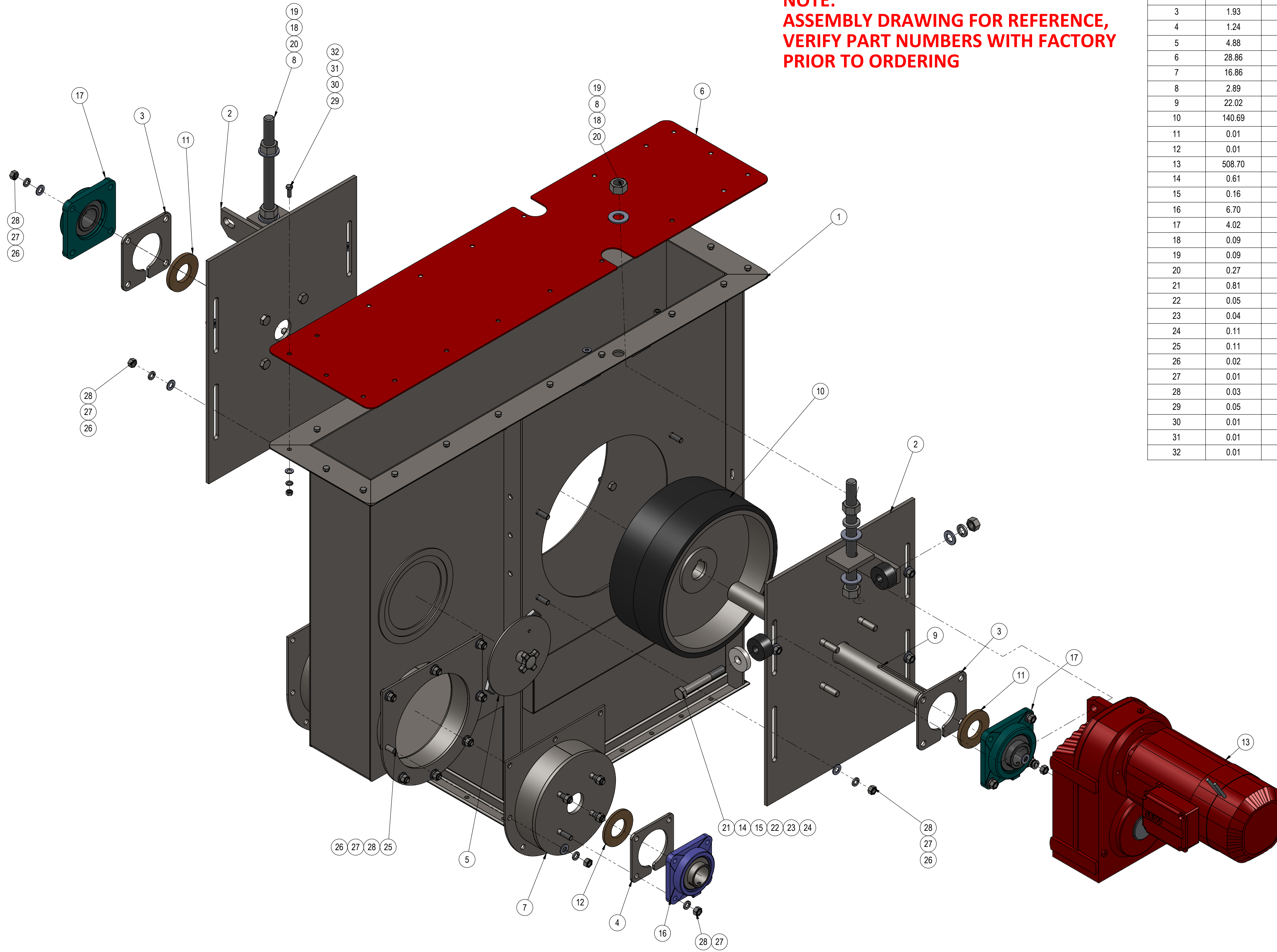

ITEM	WEIGHT	QTY.	DESCRIPTION	PART	DRAWING
1	298.55	1	Head Section Weldment, 8" x 30"	M-2695	11-2098-D
2	58.28	2	Take Up Plate	M-2493	11-1901-B
3	1.93	2	Bearing Shim Plate	M-1998	10-1215-A
4	1.24	1	Bearing Shim, 2.00 SC	M-7116	13-5838-A
5	4.88	2	INSPECTION COVER, ASSEMBLY	M-1042	09-0170-B
6	28.86	1	Elevator Head Section Top Cover, 8" x 30"	M-419671	11-2201-B
7	16.86	1	2" Flange Bearing Adaptor Plate (8" x 30" Elevator)	M-237140	11-2178-B
8	2.89	2	TAKE-UP SCREW WELDMENT, 1"-8 NC X 13" LG	M-2170	-
9	22.02	1	Head Pulley Shaft	M-677912	11-1447-B
10	140.69	1	Pulley, Head, Crowned Lagged, Single Disc, 16" OD x 6" Wide, QD/SF 2" Bushing 1/4" Lagging	M-3623	-
11	0.01	2	Shaft Felt Seal	M-676889	11-1446-A
12	0.01	1	Felt Seal	M-2940	11-2181-A
13	508.70	1	Shaft Mounted Reducer, w/Brake	M-2492	-
14	0.61	1	Torque Arm Washer	M-1665	-
15	0.16	2	Torque Arm Bushing	M-1664	-
16	6.70	1	BEARING, FLANGE, 4 BOLT, 2.000, STANDARD DUTY	M-1973	-
17	4.02	2	BEARING, FLANGE, 4 BOLT, 2.00, MEDIUM DUTY	M-2029	-
18	0.09	6	WASHER, FLAT, 1", TYPE A, STANDARD (SAE)	MH-1392	-
19	0.09	2	WASHER, LOCK, 1"	MH-1017	-
20	0.27	4	HEX NUT, 1"-8NC	MH-1035	-
21	0.81	1	HHCS, 3/4"-10NC X 5 1/2" LG	MH-1338	-
22	0.05	1	WASHER, FLAT, 3/4", TYPE A, STANDARD (SAE)	MH-1390	-
23	0.04	1	WASHER, LOCK, 3/4"	MH-1015	-
24	0.11	1	HEX NUT, 3/4"-10NC	MH-1033	-
25	0.11	8	HHCS, 1/2"-13NC X 1 1/4" LG	MH-1276	-
26	0.02	24	WASHER, FLAT, 1/2", TYPE A, STANDARD (SAE)	MH-1388	-
27	0.01	28	WASHER, LOCK, 1/2"	MH-1013	-
28	0.03	28	HEX NUT, 1/2"-13NC	MH-1031	-
29	0.05	20	HHCS, 3/8"-16NC X 1" LG	MH-1239	-
30	0.01	22	WASHER, FLAT, 3/8", TYPE A, STANDARD (SAE)	MH-1386	-
31	0.01	20	WASHER, LOCK, 3/8"	MH-1011	-
32	0.01	21	HEX NUT, 3/8"-16NC	MH-1029	-

This is a Metcast version of a 8" x 30" Head Section used on a 14 SII, ref. w/a #471837 assy on w/a drawing 79D814, ref to pin 419603 + 419670.

<small>PROPRIETARY AND CONFIDENTIAL THE INFORMATION CONTAINED IN THIS DRAWING IS THE PROPERTY OF BCT. IT IS TO BE USED ONLY FOR THE PARTS AND ASSEMBLIES IDENTIFIED BY THIS DRAWING. REPRODUCTION OR TRANSMISSION IS PROHIBITED.</small>	<small>UNLESS OTHERWISE NOTED DIMENSIONS ARE IN INCHES TOLERANCES: ANGULAR: ± 1° TWO PLACE DECIMAL: ± 0.000" THREE PLACE DECIMAL: ± 0.000"</small>			
	<small>DESCRIPTION</small> 8" x 30" Elevator Head Ass'y, 14 SII, Appleton Electric			
	<small>MODELED BY</small> RR	<small>DATE</small> 07/28/2011		<small>SIZE</small> D
	<small>DO NOT SCALE DRAWING</small>			<small>SCALE: 1:5</small>
<small>EST WT: 1173.4#</small>			<small>REV</small> 0	
<small>SHEET 1 OF 1</small>			<small>DWG NO</small> 11-2190-B	